

# HOUSE & LAND PACKAGES

**110 WHITEBOX STREET,  
ORANGE**

## FEATURES INCLUDE

- Three bedrooms - luxurious master retreat with ensuite and generous walk-in robe.
- A covered alfresco space off the main kitchen, perfect for outdoor dining.
- Bedrooms 2, & 3 have built-in robes.
- Ducted gas heating to ensure maximum comfort during the cooler seasons.
- A modern gallery style kitchen with a walk-in pantry, Westinghouse appliances and a Laminex bench top, customised to your personal style.
- Kitchen design includes your choice of Sheen or Satin profile doors & draws in your selected colours.
- Roller blinds from our exclusive range to all living areas and bedrooms.
- Your choice of Haus 25, Misha, Lina or Platz in chrome tapware and accessories.
- A 3000L water tank for all of your extra water storage.
- In house drafting services to help make any changes to your plan.
- Guidance from our professional design team during all of your selection appointments.
- A home ready for you to move in and enjoy!



**\$665,000**

## DIMENSIONS

Living: 5.00 x 4.00  
 Kitchen: 8.00 x 3.60  
 Master: 4.07 x 3.75  
 Bed 2: 3.00 x 3.10  
 Bed 3: 3.00 x 3.15

Floor Area: 136.9m<sup>2</sup>  
 Garage: 34.9m<sup>2</sup>  
 Alfresco: 8.8m<sup>2</sup>  
 Porch: 5.2m<sup>2</sup>  
 Total Area: 171.5m<sup>2</sup> / 18.5sq

# HOUSE & LAND PACKAGES

**110 WHITEBOX STREET,  
ORANGE**

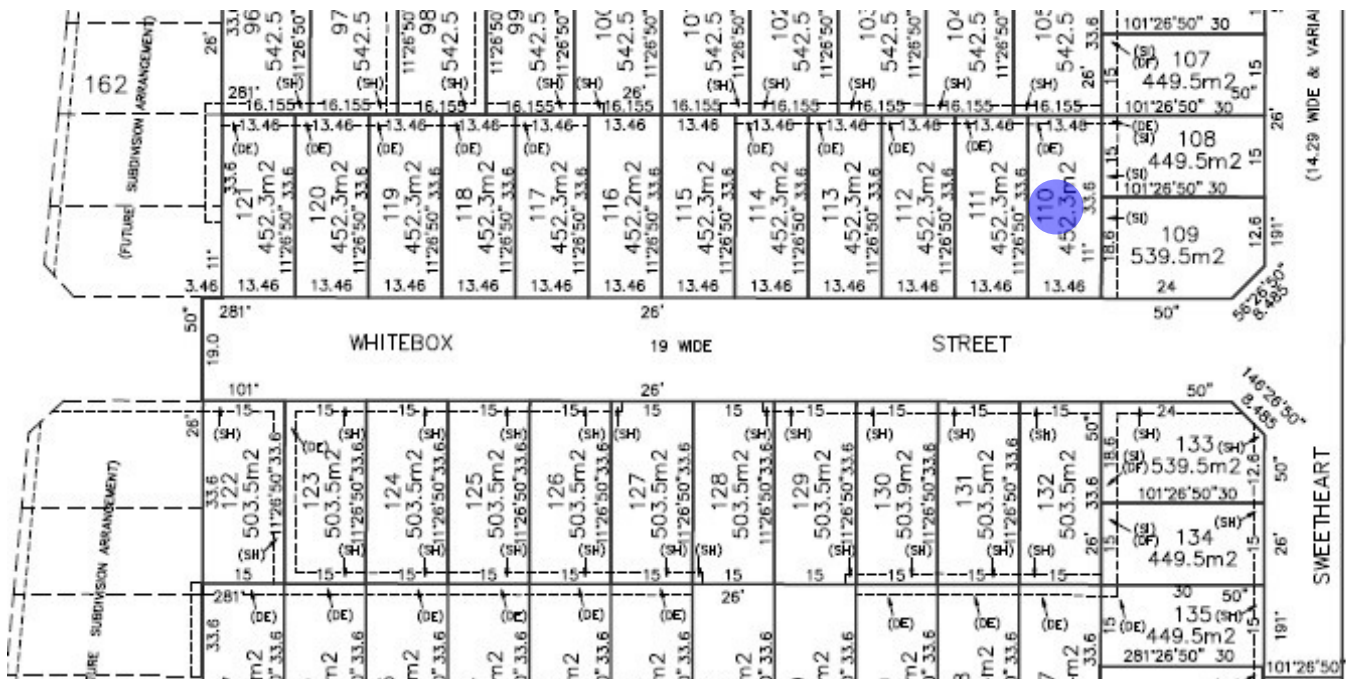

## ABOUT SHIRALEE ESTATE

Lot 110 Whitebox Street is 452.3m<sup>2</sup> block in Shiralee Estate, located in the picturesque South Orange. Only a short 3.2km away from the CBD, 1km from Orange Christian School and 3.5km from Orange High School, this block is perfect for families with children attending schools near by or someone looking to move into a private community. Connecting to the Southern Feeder for easy access to health services and the Mines. The mixed use village center in Shiralee Estate is in the works for your convenience.

## CONTACT DETAILS

Michael Paddison  
0414 447 467  
[info@contemporaryhomes.net.au](mailto:info@contemporaryhomes.net.au)

Tisha Ataria  
0428 777 651  
[sales@contemporaryhomes.net.au](mailto:sales@contemporaryhomes.net.au)



\*please note that this plan does not have to be built on this block, if there is one you think will suit this block better please let our team know and we can quote you for that home and your preferred inclusions\*